

# COCO GROW SCHEDULE



		Cultivation period in weeks	Light / Day in hours	COCO A&B ml A/10 litres ml B/10 litres	PK 13/14 ml/10 litres	EC + in mS/cm	
GROWTH	<b>Start / rooting (3 - 5 days) -</b> Water the substrate.	< 1	18	15 - 25	-	0.7 - 1.1	VEGETATIVE PHASE
	<b>Vegetative phase I -</b> Plants develop in volume.	0 - 3 <sup>1</sup>	18	20 - 30	-	0.9 - 1.3	
FLOWERING	<b>Vegetative phase II -</b> Up to growth stagnation after fructification or appearance of the formation of flowers.	2 - 4 <sup>2</sup>	12	25 - 35	-	1.1 - 1.5	GENERATIVE PHASE
	<b>Generative Period I -</b> Flowers or fruits develop in length. Growth in height achieved.	2 - 3	12	30 - 40	-	1.4 - 1.8	
	<b>Generative period II -</b> Development of the volume (breadth) of flowers or fruit.	1	12	30 - 40	15	1.6 - 2.0	
	<b>Generative Period III -</b> Development of the mass (weight) of flowers or fruit.	2 - 3	12	20 - 30	-	1.0 - 1.4	
	<b>Generative Period IV -</b> Flowers or fruit ripening process.	1 - 2	10 - 12 <sup>3</sup>	-	-	0.0	

- <sup>1</sup> This period varies depending on the species and number of plants per m<sup>2</sup>. Mother plants remain in this phase until the end (6 - 12 months).
- <sup>2</sup> The changeover from 18 to 12 hours varies depending on the variety. The rule of thumb is to change after 2 weeks.
- <sup>3</sup> Reduce hours of light if ripening goes too fast. Watch out for increasing relative humidity.

Make your personal feeding grow schedule at [canna.co.za](https://canna.co.za)

EC: EC+ value is based in mS/cm when EC water = 0.0 at 25°C, pH 6.0. Add the EC of the tap water that is used to the recommended EC! The EC total in the example is with tap water with an EC of 0.4.  
pH: Recommended pH is between 5.5 and 6.2.

The guidelines in the table aren't an iron law, but can help novice growers to develop a sophisticated fertilization strategy. The optimum fertilization strategy is further determined by factors such as: temperature, humidity, plant species, root volume, moisture percentage in substrate, water dosage strategy, etc.



# CANNA COCO



Two-part nutrient for growing and flowering • Easy to use  
RHP certified quality Coco substrate • Pre-buffered, not steam sterilized coco  
Coco available in bag or compressed Brick



## About CANNA

CANNA is the producer of nutrients and growing mediums for the cultivation of fast growing plants. CANNA was founded in the Netherlands in the early 90s. All CANNA products are scientifically tested before being placed on the global market. Passion and love for plants and helping growers achieve the most optimal result characterizes CANNA's philosophy.

The key to CANNA's success is the quality and consistency of the products. CANNA believes in sharing of knowledge and experience to help growers. CANNA's passionate scientists put years of extensive research in each product which has resulted in formulas that guarantee that everyone, including inexperienced growers, achieve amazing results!

Connect with us on  or 



## CANNA COCO

CANNA COCO is a line of nutrients and substrates which are specially developed for growing plants in coco. CANNA was the first to introduce Coco substrate to the hydroponics market including its unique Coco A&B fertilizer matching the characteristics of the substrate.

## CANNA Coco A&B

CANNA Coco A&B is a two-part nutrient for plants and can be used for the growing and flowering phase. Use in combination with a quality coco growing medium. CANNA Coco A&B is easy to use, dissolves directly and is suitable for growing in pots or with "run to waste" systems. Thanks to the special characteristics of coco substrate CANNA COCO doesn't have a Vega and Flores variant, but there is one formulation for both the growth and blooming phase.

CANNA COCO nutrients consist of two parts, an A part and a B part. We separate these because if they are mixed, the formula clogs together and the plant cannot absorb this. That's why you should first add the A component, stir well and then add the B component.

NPK Fertilizer solution  
NPK 5-2-2 with Ca, Mg



**CANNA Coco A**  
N Fertilizer solution  
N 4 with Ca

Reg No. B 5972 Act. No. 36 of 1947  
Group 2 fertilizer



**CANNA Coco B**  
PK Fertilizer solution  
PK 2-2 with Mg

Reg No. B 5978 Act. No. 36 of 1947  
Group 2 fertilizer



## CANNA Coco substrate

CANNA Coco Professional Plus is the highest quality Coco that CANNA is known for worldwide; pre-buffered, not steam sterilized, RHP certified, re-useable and the perfect combination with CANNA Coco nutrients. This growing medium is perfect for growing vegetables, herbaceous, fruit bearing and flowering plants. CANNA Coco substrate is a 100% natural product having a fine, uniform structure, free from viruses, chemical additives and soil diseases.

The fact that CANNA Coco is not steamed is not the only thing that distinguishes it from other substrates; this is also achieved by the use of pure, first class source materials which come from India, where CANNA's production facilities use fresh water only to soak the coco. This to make sure no salts gets in contact with CANNA Coco, ensuring a clean product.



## CANNA Coco Professional Plus 50L Bag

This bag of CANNA Coco Professional Plus contains 50 liter of ready to use loose Coco coir. CANNA Coco Professional Plus is washed and buffered to ensure a perfect growing medium for your plants. Coir fibre pith has an excellent water / air system, which provides ideal conditions for growing and allows for a rapid development of the crop from the start of the cultivation. CANNA Coco Professional Plus is not pre-fertilised so it is important to add nutrients according to the specific plants' needs.

pH (water)zone: 5.5 - 7.0

EC: < 0.6 mS/cm



## CANNA Coco Professional Plus 40L Brick

The Coco Professional Plus Brick is the CANNA quality Coco, compressed in 2 blocks of 20 liter and ready to use in no time. CANNA is the first that invented and developed a way to eliminate the downside of using bricks. The result is a brick of the highest quality buffered coco that expands extremely fast and is easy to use. The holes in the CANNA Coco Brick causes the brick to expand faster and easier than you have ever seen before. No more endless stirring and waiting for the coco to finally be ready to use.

Each brick has a fracture line which gives you the option to easily prepare smaller amounts of coco if desired (4 x 10 Liter). Due to the compressed nature of the brick it takes up very little storage space which in turn, makes it very easy to transport.

pH (water)zone: 5.5 - 7.0

EC: < 0.6 mS/cm

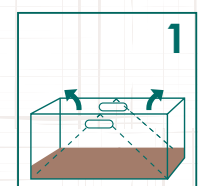
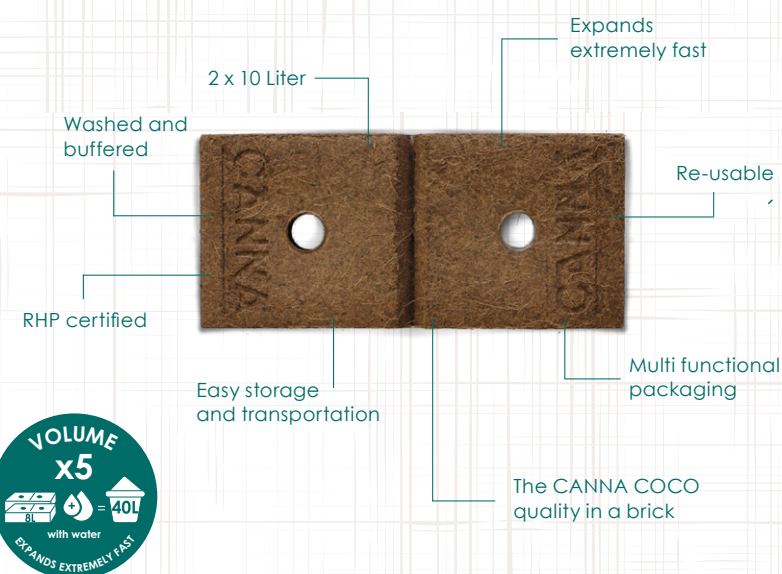

Open the bag

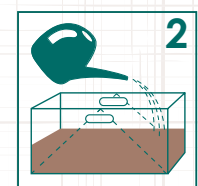

Add clean water

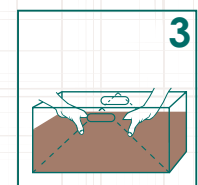

Loosen the coco